

UNSHIELDED SMD HIGH CURRENT POWER INDUCTORS / BS TYPE

FEATURES

- ◆ Miniature surface mount design.
- ◆ High power, High saturation inductors.
- ◆ Very low resistance.
- ◆ Ideal inductors for DC-DC conversion.

APPLICATIONS

- ◆ Notebook
- ◆ PDA Step-up and step-down converters
- ◆ Power supply for VTRs.
- ◆ LCD televisions.



ORDERING CODE

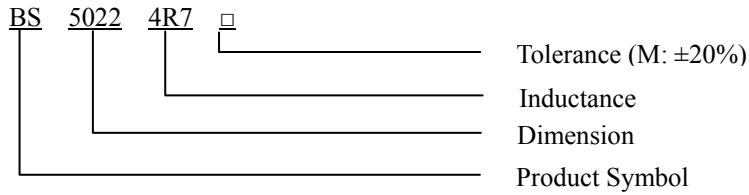

DIMENSIONS: (UNIT: mm)

A	22.35 (MAX)	m/m
B	16.26 (MAX)	m/m
C	7.87 (MAX)	m/m

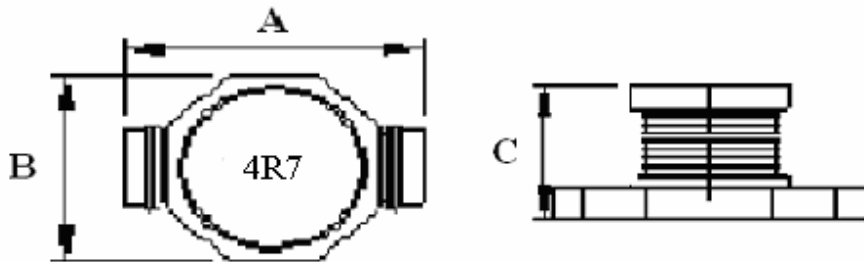

CORE MASTER ENTERPRISE CO., LTD.

<http://www.coremaster.com.tw>

UNSHIELDED SMD HIGH CURRENT POWER INDUCTORS / BS TYPE

ELECTRICAL CHARACTERISTICS FOR BS5022

Part No.	Inductance (μ H)	RDC (Ω)	IDC (A)
BS5022-R78 □	0.78	0.004	30.0
BS5022-1R5 □	1.50	0.010	20.0
BS5022-2R2 □	2.20	0.016	20.0
BS5022-3R3 □	3.30	0.018	20.0
BS5022-4R7 □	4.70	0.025	20.0
BS5022-100 □	10	0.030	14.5
BS5022-120 □	12	0.033	13.6
BS5022-150 □	15	0.036	12.0
BS5022-470 □	47	0.087	7.0
BS5022-680 □	68	0.122	6.0
BS5022-151 □	150	0.250	4.0
BS5022-221 □	220	0.330	3.5
BS5022-331 □	330	0.490	2.5



CORE MASTER ENTERPRISE CO., LTD.

<http://www.coremaster.com.tw>