

SHIELDED RADIAL CHOKE INDUCTORS / SRC TYPE

FEATURES

- ◆ Low distortion.
- ◆ Ferrite Shielded.



APPLICATIONS

- ◆ Magnetically shielded construction.
- ◆ Ideally Used in Printers, LCD TV, DVD, Printer, Copy Machine, Main board of the compounding machines, etc as Power Supplies's Inductors or DC-DC Converter inductors.

ORDERING CODE

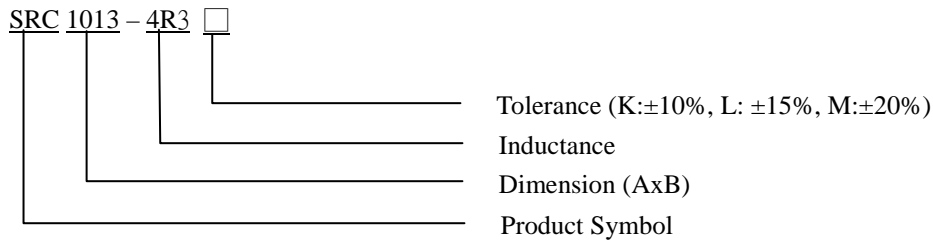

SHAPES

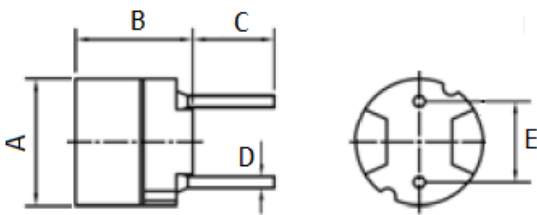

Fig. 1

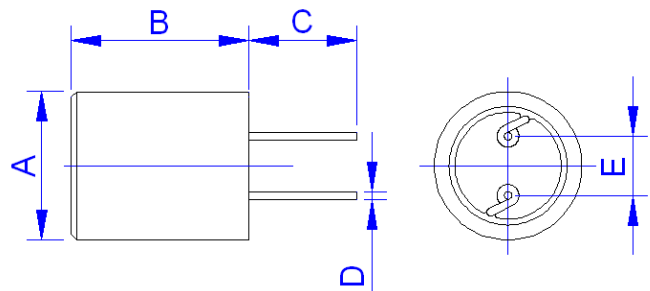

Fig. 2

DIMENSIONS UNIT: mm

Part No.	Fig.	A (MAX)	B (MAX)	C (REF)	D (REF)	E (REF)
SRC0606	1	6.5	7.0	5.0	0.5	4.0
SRC0807	1	8.3	7.8	5.0	0.6	5.0
SRC1013	2	11	14.5	5.0	0.7	5.0
SRC1317	2	14	18.5	5.0	0.7	5.0
SRC1616	2	17	17.5	5.0	0.8	7.5
SRC1619	2	17	20.5	5.0	1.0	7.5

*DESIGN AS CUSTOMER'S REQUESTED SPECIFICATIONS



CORE MASTER ENTERPRISE CO., LTD.

<http://www.coremaster.com.tw>