

# SHIELDED SMD POWER INDUCTORS / FPI (S) TYPE

## FEATURES

- ◆ Excellent solderability and high Heat resistance
- ◆ Excellent terminal strength construction
- ◆ Shielded with magnetic resin
- ◆ Closed magnetic design



## APPLICATIONS

- ◆ Power supply for VTRs.
- ◆ Portable communication equipment.
- ◆ Notebook PCs.
- ◆ LCD televisions.
- ◆ DC/DC converters, etc.

## ORDERING CODE

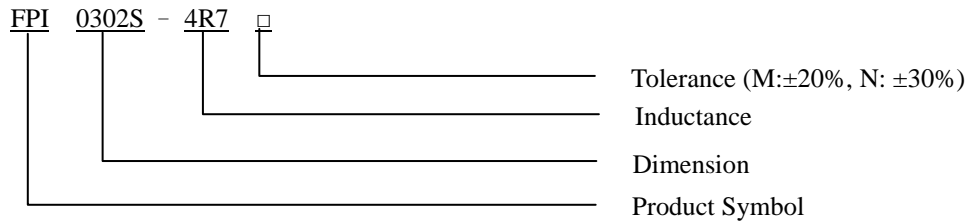

## DIMENSIONS (UNIT: mm)

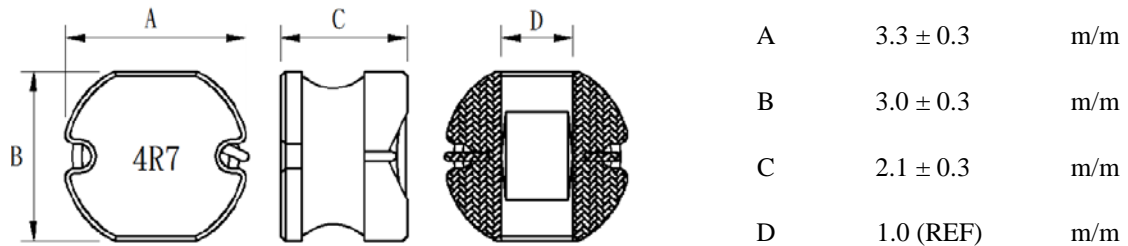

CORE MASTER ENTERPRISE CO., LTD.



<http://www.coremaster.com.tw>

## SHIELDED SMD POWER INDUCTORS / FPI(S) TYPE

### ELECTRICAL CHARACTERISTICS FOR FPI0302S

Part No.	Inductance (uH)	RDC ( $\Omega$ )	IDC (A)
FPI0302S-1R0 □	1.0	0.054	4.00
FPI0302S-1R5 □	1.5	0.085	3.20
FPI0302S-2R2 □	2.2	0.120	2.50
FPI0302S-2R7 □	2.7	0.140	2.40
FPI0302S-3R3 □	3.3	0.180	2.30
FPI0302S-4R7 □	4.7	0.200	2.20
FPI0302S-5R6 □	5.6	0.210	1.70
FPI0302S-6R8 □	6.8	0.350	1.50
FPI0302S-100 □	10	0.360	1.40
FPI0302S-150 □	15	0.450	1.13
FPI0302S-180 □	18	0.490	0.90
FPI0302S-220 □	22	0.600	0.80
FPI0302S-270 □	27	0.750	0.70
FPI0302S-470 □	47	1.200	0.50
FPI0302S-680 □	68	1.900	0.45

\* Test Frequency : 100KHZ/0.25V