

SHIELDED SMD POWER INDUCTORS / FPI (S) TYPE

FEATURES

- ◆ Excellent solderability and high Heat resistance
- ◆ Excellent terminal strength construction
- ◆ Shielded with magnetic resin
- ◆ Closed magnetic design



APPLICATIONS

- ◆ Power supply for VTRs.
- ◆ Portable communication equipment.
- ◆ Notebook PCs.
- ◆ LCD televisions.
- ◆ DC/DC converters, etc.

ORDERING CODE

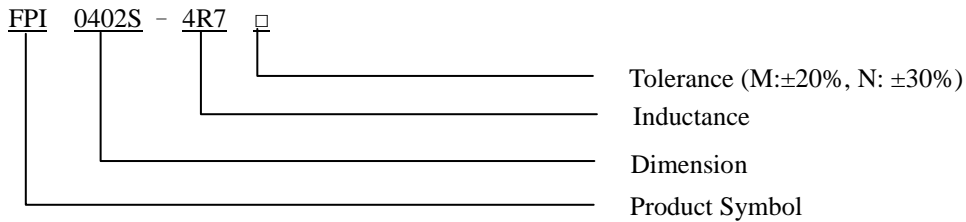

DIMENSIONS (UNIT: mm)

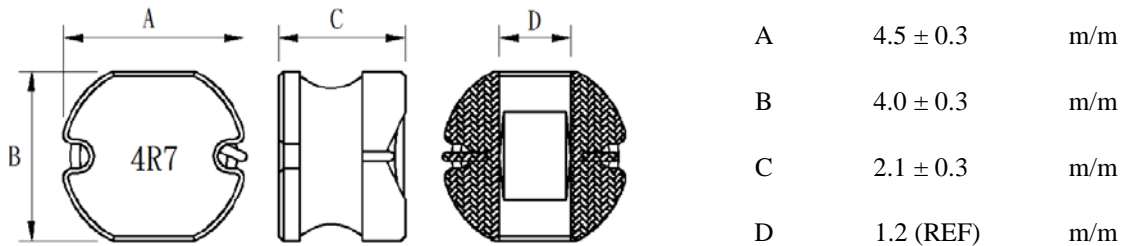

SHIELDED SMD POWER INDUCTORS / FPI (S) TYPE

ELECTRICAL CHARACTERISTICS FOR FPI0402S

Part No.	Inductance (uH)	RDC (Ω)	IDC (A)
FPI0402S-1R0 □	1.0	0.020	5.40
FPI0402S-1R5 □	1.5	0.025	4.57
FPI0402S-2R2 □	2.2	0.036	3.50
FPI0402S-3R3 □	3.3	0.051	2.80
FPI0402S-4R7 □	4.7	0.063	2.60
FPI0402S-6R8 □	6.8	0.108	2.05
FPI0402S-100 □	10	0.140	1.70
FPI0402S-150 □	15	0.230	1.35
FPI0402S-220 □	22	0.360	1.17
FPI0402S-330 □	33	0.530	0.94
FPI0402S-470 □	47	0.760	0.79
FPI0402S-680 □	68	0.860	0.65
FPI0402S-101 □	100	1.310	0.54

* Test Frequency : 100KHZ/0.25V



CORE MASTER ENTERPRISE CO., LTD.

<http://www.coremaster.com.tw>