

SHIELDED SMD POWER INDUCTORS / FPI (S) TYPE

FEATURES

- ◆ Excellent solderability and high Heat resistance
- ◆ Excellent terminal strength construction
- ◆ Shielded with magnetic resin
- ◆ Closed magnetic design



APPLICATIONS

- ◆ Power supply for VTRs.
- ◆ Portable communication equipment.
- ◆ Notebook PCs.
- ◆ LCD televisions.
- ◆ DC/DC converters, etc.

ORDERING CODE

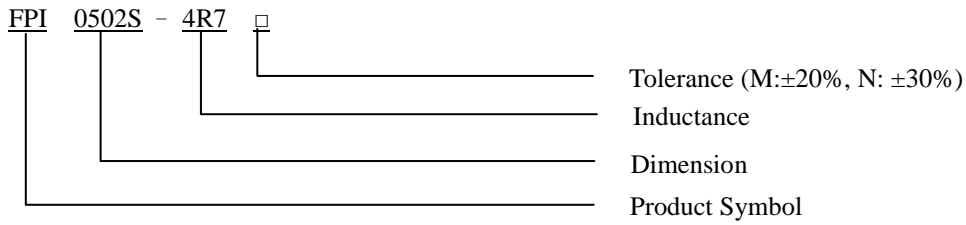

DIMENSIONS (UNIT: mm)

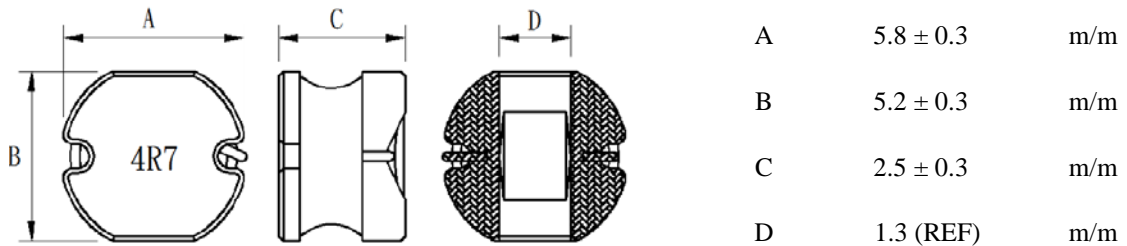

SHIELDED SMD POWER INDUCTORS / FPI (S) TYPE

ELECTRICAL CHARACTERISTICS FOR FPI0502S

Part No.	Inductance (uH)	RDC (Ω)	IDC (A)
FPI0502S-1R0 □	1.0	0.020	4.10
FPI0502S-1R5 □	1.5	0.026	3.80
FPI0502S-2R2 □	2.2	0.032	3.20
FPI0502S-3R3 □	3.3	0.043	2.55
FPI0502S-4R7 □	4.7	0.057	2.50
FPI0502S-6R8 □	6.8	0.083	2.05
FPI0502S-100 □	10	0.110	1.70
FPI0502S-150 □	15	0.170	1.35
FPI0502S-220 □	22	0.230	1.15

* Test Frequency : 100KHZ/0.25V