

SMD POWER INDUCTORS / WDI TYPE

FEATURES

- ◆ The series is a range of miniature, surface-mount.
- ◆ I-core power inductors.
- ◆ Suitable for and reflow soldering.
- ◆ They are designed for use in power applications with restricted PCB space and height.



APPLICATIONS

- ◆ Personal computers.
- ◆ Pagers, Cordless phone.
- ◆ High Freq. Communication Products.
- ◆ Disk Drives and computer peripherals.
- ◆ DC power supply circuits.

ORDERING CODE

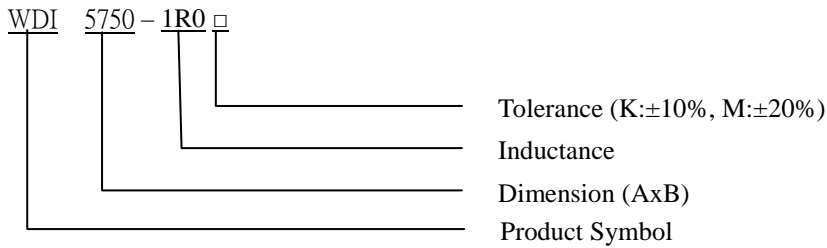

DIMENSIONS: (UNIT: mm)

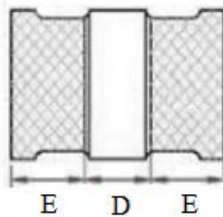
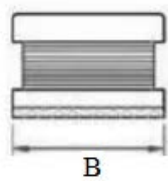
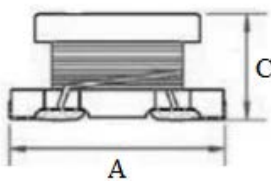

A	5.7 ± 0.3	m/m
B	5.0 ± 0.3	m/m
C	4.7 ± 0.3	m/m
D	1.7 (MIN)	m/m
E	1.3 (MIN)	m/m

SMD POWER INDUCTORS / WDI TYPE

ELECTRICAL CHARACTERISTICS FOR WDI5750

Part No.	Inductance (μ H)	Test Frequency (MHz)	RDC (Ω)Max	IDC (A) Max
WDI 5750-1R0 □	1.0	1MHz	0.027	4.00
WDI 5750-1R5 □	1.5	1MHz	0.031	3.70
WDI 5750-2R2 □	2.2	1MHz	0.041	3.20
WDI 5750-3R3 □	3.3	1MHz	0.050	2.90
WDI 5750-4R7 □	4.7	1MHz	0.057	2.70
WDI 5750-6R8 □	6.8	1MHz	0.104	2.00
WDI 5750-100 □	10	1MHz	0.130	1.70
WDI 5750-150 □	15	1MHz	0.210	1.40
WDI 5750-220 □	22	1MHz	0.266	1.20
WDI 5750-330 □	33	1MHz	0.448	0.90
WDI 5750-470 □	47	1MHz	0.560	0.80
WDI 5750-680 □	68	1MHz	0.938	0.64
WDI 5750-101 □	100	100KHz	1.204	0.56
WDI 5750-151 □	150	100KHz	2.660	0.42
WDI 5750-221 □	220	100KHz	3.360	0.32
WDI 5750-331 □	330	100KHz	6.160	0.27
WDI 5750-471 □	470	100KHz	7.560	0.24
WDI 5750-681 □	680	100KHz	11.340	0.19
WDI 5750-102 □	1000	10KHz	14.420	0.15

Notes:

- 1) Test Equipment : HP4284A or WK3260B LCR Meter.
- 2) DCR limits @ 20°C. Test Equipment: CH502BC.