

SHIELDED SMD POWER INDUCTORS / FPI (S) TYPE

FEATURES

- ◆ Excellent solderability and high Heat resistance
- ◆ Excellent terminal strength construction
- ◆ Shielded with magnetic resin
- ◆ Closed magnetic design



APPLICATIONS

- ◆ Power supply for VTRs.
- ◆ Portable communication equipment.
- ◆ Notebook PCs.
- ◆ LCD televisions.
- ◆ DC/DC converters, etc.

ORDERING CODE

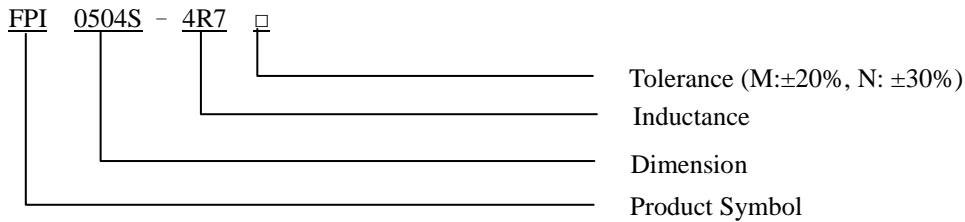

DIMENSIONS (UNIT: mm)

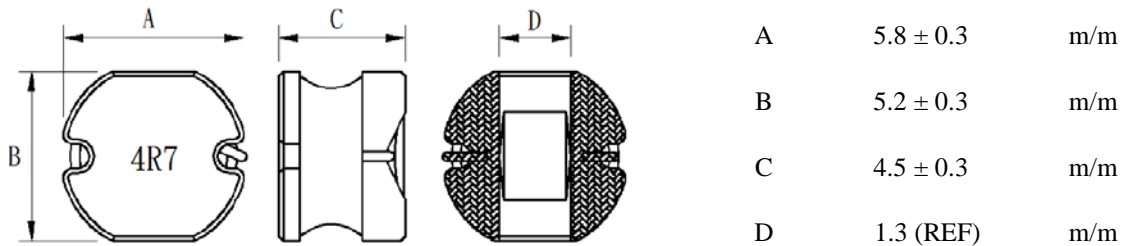

SHIELDED SMD POWER INDUCTORS / FPI(S) TYPE

ELECTRICAL CHARACTERISTICS FOR FPI0504S

Part No.	Inductance (uH)	RDC (Ω)	IDC (A)
FPI0504S-1R0 □	1.0	0.014	8.50
FPI0504S-1R5 □	1.5	0.018	7.60
FPI0504S-1R8 □	1.8	0.020	7.00
FPI0504S-2R2 □	2.2	0.025	6.00
FPI0504S-3R3 □	3.3	0.030	5.00
FPI0504S-4R7 □	4.7	0.038	4.00
FPI0504S-6R8 □	6.8	0.047	3.80
FPI0504S-8R2 □	8.2	0.060	3.30
FPI0504S-100 □	10	0.070	3.00
FPI0504S-150 □	15	0.100	2.30
FPI0504S-220 □	22	0.140	1.90
FPI0504S-330 □	33	0.190	1.50
FPI0504S-470 □	47	0.260	1.30
FPI0504S-680 □	68	0.350	1.00
FPI0504S-101 □	100	0.490	0.80

* Test Frequency : 100KHZ/0.25V